

WUNDERLICH METAL TILE ROOFING

Details and Fixing Instructions

The details illustrated on the following pages show clearly the method of fixing Wunderlich Metal Tile Roofing. Developed to relieve the acute Roofing shortage, and to make possible the completion of unfinished Homes, Wunderlich Metal Tile is stamped from 24 gauge Zincanneal and Stove (synthetic) Enamelled an attractive Russet-Red. It forms a thoroughly watertight Roof covering, that is light in weight and is easy and economical to transport.

Wunderlich Metal Tile Roofing (and accessories) is Manufactured as follows:—

- No. 1838 Sheetting 5' 10½" x 2' 11½" (16 Tiles to a sheet)
- No. 1839 Half Sheet—8 Tiles in a row
- No. 1840 L.H. Hip Starter Sheet
- No. 1841 R.H. Hip Starter Sheet
- No. 1842 R.H. Valley Starter Sheet
- No. 1843 L.H. Valley Starter Sheet
- No. 1844 Ridge or Hip Capping in 6' lengths
- No. 1845 Hip Starter in 6' lengths

WE DO NOT QUOTE FOR FIXING, BUT ON RECEIPT OF AN ORDER AND ROOF PLAN, WE PROVIDE A DRAWING SHOWING THE SET-OUT OF METAL TILING AND QUANTITIES INVOLVED.

SAFETY FIRST: USE A ROOF LADDER WHEN FIXING METAL TILE ROOFING.

A PRODUCT OF THE METAL WORKING DIVISION OF
WUNDERLICH LIMITED

108-110 BRUNSWICK STREET, VALLEY, BRISBANE - - - - Phone : L 2751

Wunderlich
METAL TILE ROOFING
STAMPED AND STOVE ENAMELLED ZINCANNEAL

**PART SECTION OF
ROOF SHOWING
HIP & VALLEY
STARTING
SHEETS.**

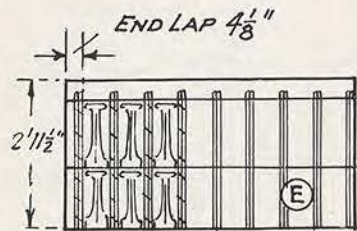
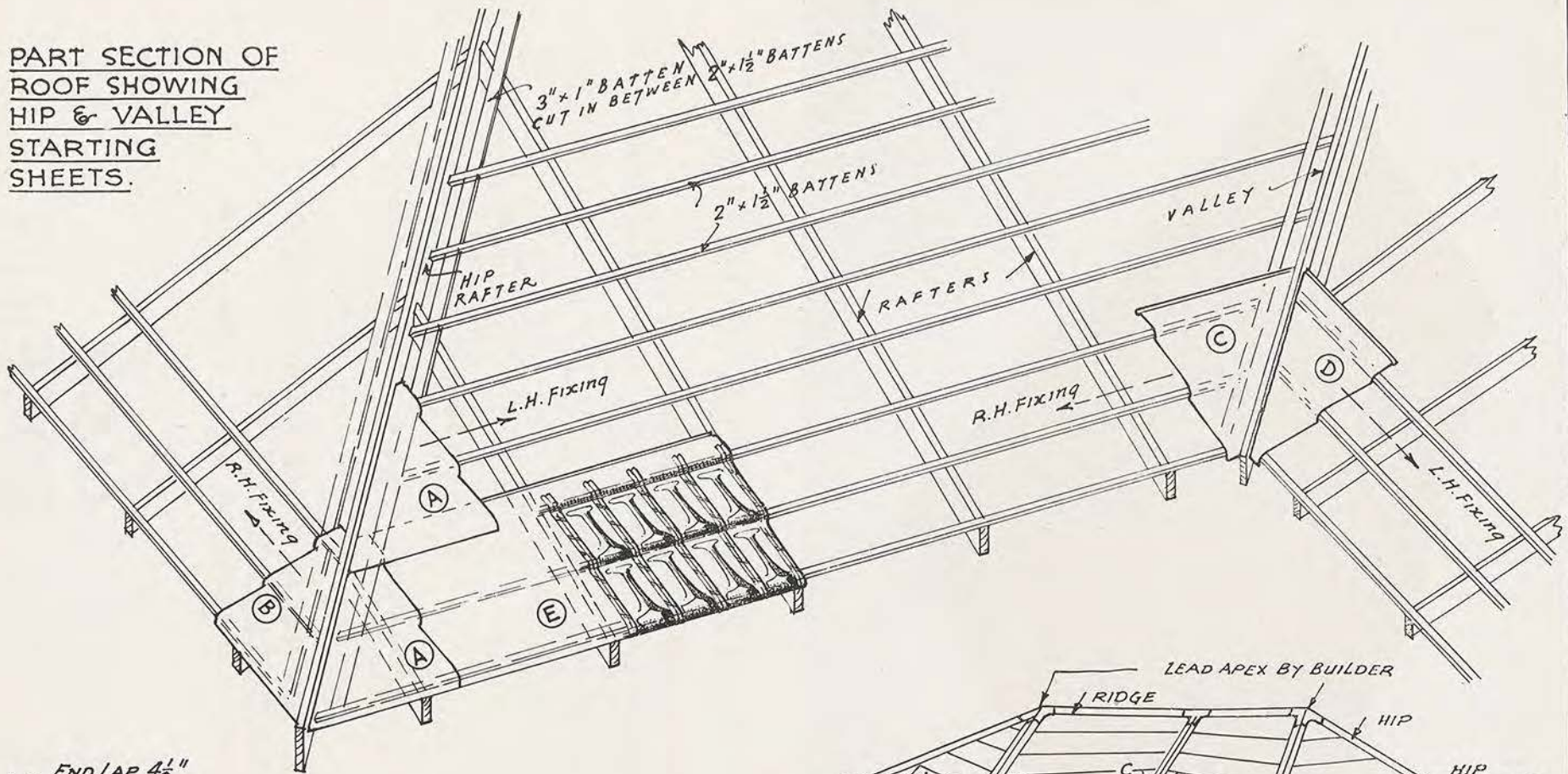

**FULL SHEET
No 1838**

TOP LAP $4\frac{1}{2}''$
24 GAUGE ZINC ANNEAL
TILE SHEET SIZE $5'10\frac{3}{8}'' \times 2'11\frac{1}{2}''$
16 TILES PER SHEET
COVERAGE $5'6\frac{3}{8}'' \times 2'7''$

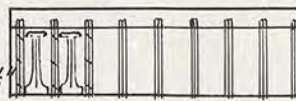

**HALF SHEET (8 TILES)
No 1839**

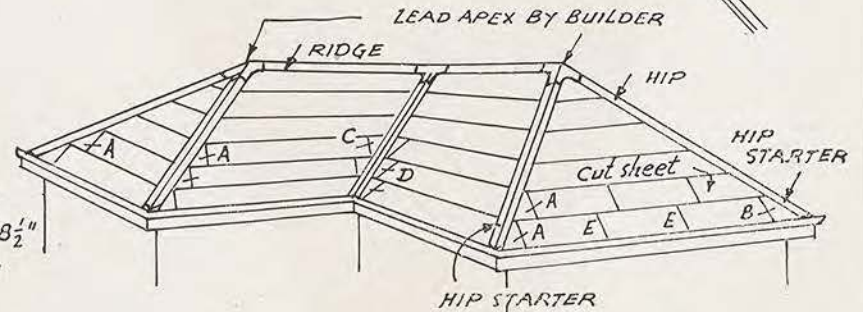

**SKETCH SHOWING APPLICATION
OF ROOF TILE SHEETING.**

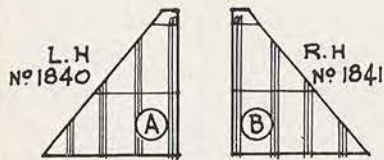

HIP STARTING SHEETS

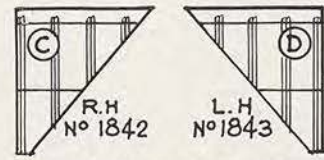

VALLEY STARTING SHEETS



HIP & RIDGE CAPPING No 1844

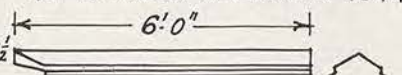

HIP STARTER No 1845

**NOTE.. Type of starting sheet usable (L.H or R.H)
is determined by "hand of fixing" adopted.**

WUNDERLICH LIMITED. REDFERN, N. S. W

**FIXING DETAIL OF METAL
ROOF TILE SHEETING.**

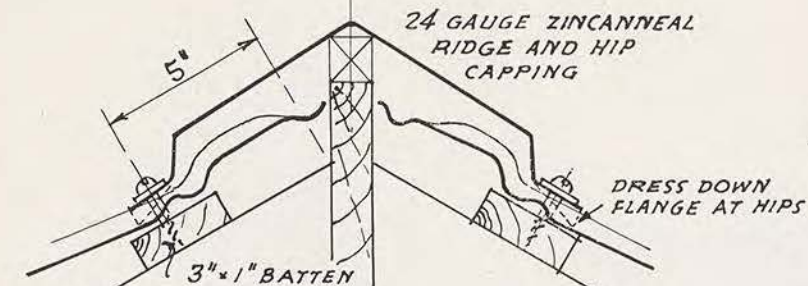

SECTION THRU RIDGE
AND HIP.

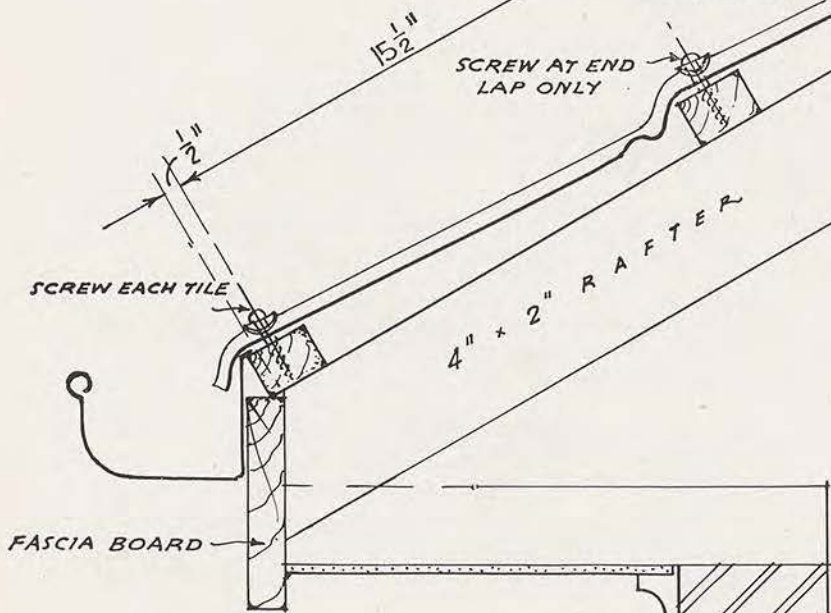
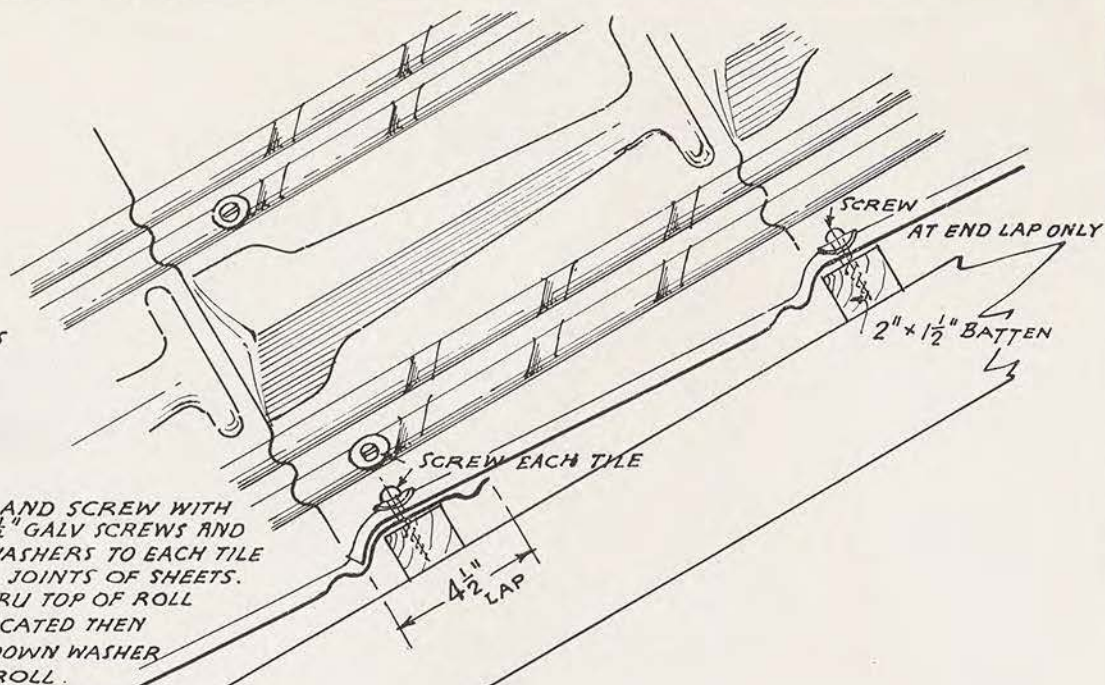

SECTION THRU EAVES

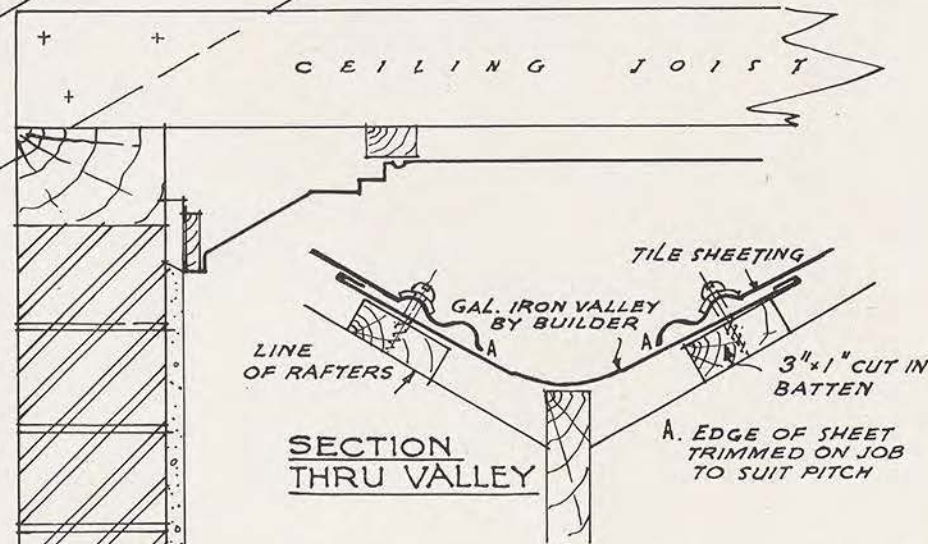

SECTION
THRU VALLEY

WUNDERLICH LIMITED. REDFERN. N. S. W

FIXING DETAIL OF METAL
ROOF TILE SHEETING.

691.0994
Wunderlich
Roo/013

MINIMUM SIZES OF TIMBERING FOR WUNDERLICH METAL TILE ROOFING.

- RAFTERS.** For unsupported length not exceeding 6'0" use 3"x2" Hardwood at 3'0" centres Oregon or other "D" class timbers, 4"x2" at 3'0" centres.
 Unsupported length not exceeding 8'0" H.W. Oregon or other "D" class timbers 4"x2"
- BATTENS.** For rafter spacing not exceeding 3'0" Hardwood, 2"x1½" on flat, 3"x1" at ridge hips & valleys (See detail sheet 2) Oregon or other "D" class timbers use 2"x1½" on edge with 3"x1½" at ridge hips & valleys.
- SCREWS.** Average 11 screws for each 5'10½" x 2'11½" sheet which is sufficient to fix sheeting and accessories

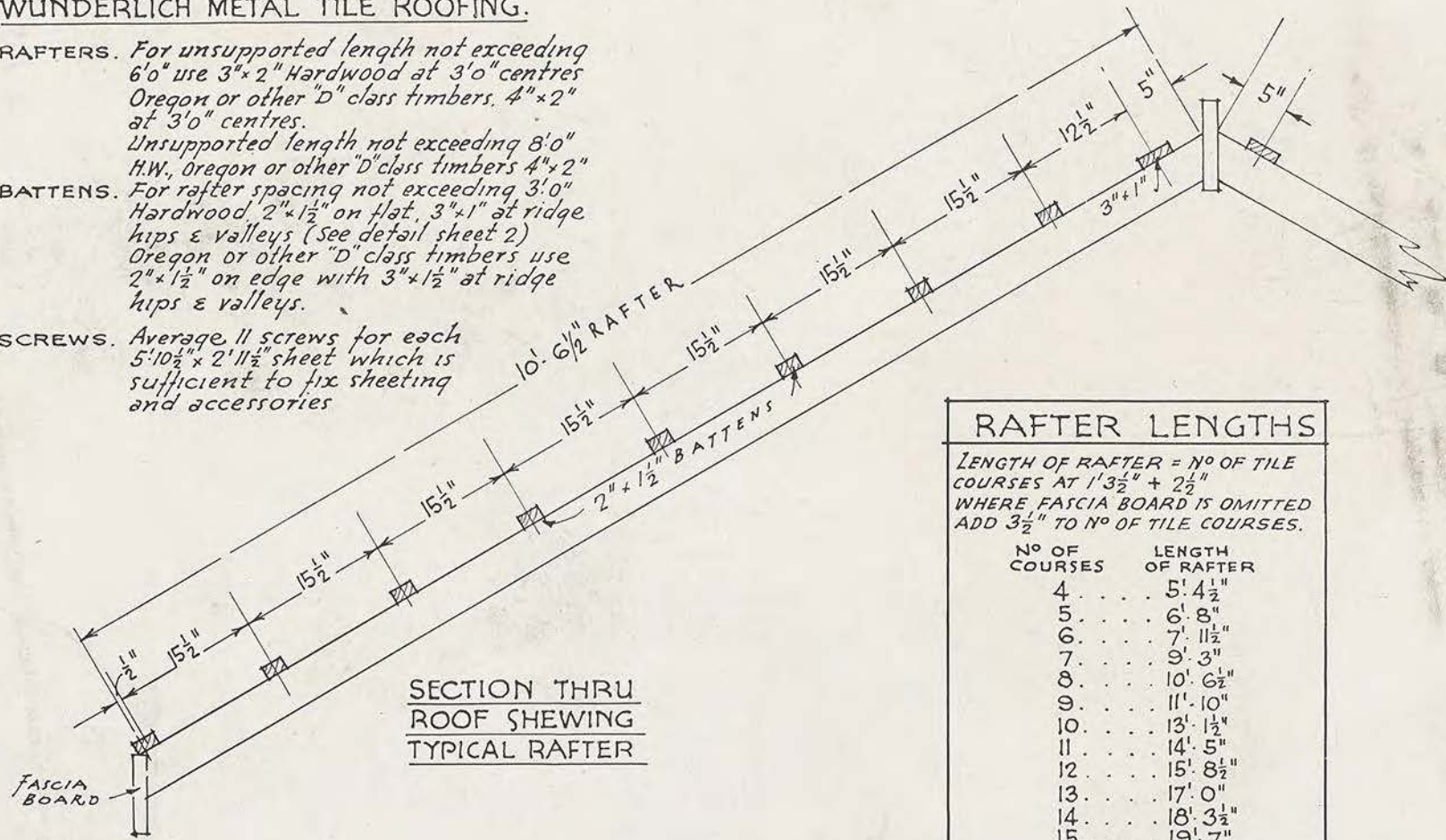

RAFTER LENGTHS	
LENGTH OF RAFTER = NO OF TILE COURSES AT 1'3½" + 2½"	
WHERE FASCIA BOARD IS OMITTED ADD 3½" TO NO OF TILE COURSES.	
NO OF COURSES	LENGTH OF RAFTER
4	5' 4½"
5	6' 8"
6	7' 11½"
7	9' 3"
8	10' 6½"
9	11' 10"
10	13' 1½"
11	14' 5"
12	15' 8½"
13	17' 0"
14	18' 3½"
15	19' 7"
16	20' 10½"

WUNDERLICH LIMITED, REDFERN, N. S. W.
 TIMBERING FOR METAL ROOF TILE SHEETING
 SHEET 3

88817013615670

SPAM